

IMPORTANT SAFEGUARDS READ AND FOLLOW ALL SAFETY INSTRUCTIONS.

When using electrical equipment, basic safety precautions should always be followed including the following:

- **DISCONNECT AC POWER SUPPLY BEFORE SERVICING.**
- Installation and servicing of this equipment should be performed by qualified service personnel only.
- Ensure that the electrical wiring conforms to the National Electrical Code NEC® and local regulations if applicable.
- Do not mount near gas or electric heaters.
- Equipment should be mounted in locations and at heights where it will not be readily subjected to tampering by unauthorized personnel.
- The use of accessory equipment not recommended by the manufacturer may cause an unsafe condition.
- Any modification or use of non-original components will void the warranty and product liability.
- Do not use this equipment for other than intended use.

SAVE THESE INSTRUCTIONS!

1. Remove the (4) corner screws to detach the cover from the backplate and then unplug the electrical connectors. (Fig. 1)

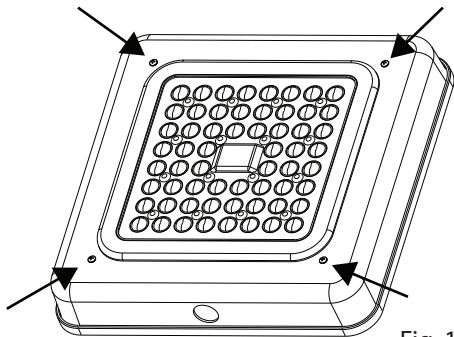

Fig. 1

2. Remove the necessary knockouts and mount the backplate to the junction box using the provided foam gasket and appropriate hardware (provided by others) for this application. (Fig. 2)

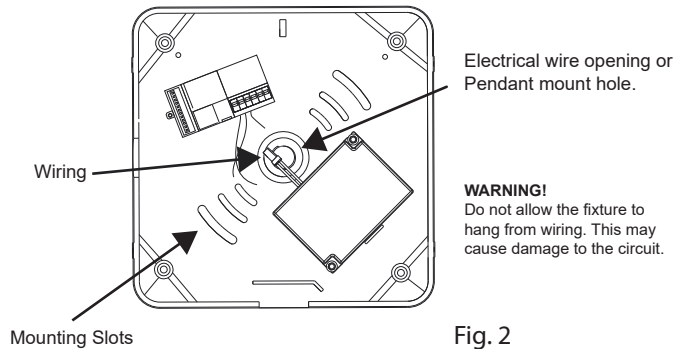

Fig. 2

3. Electrical Connections should be made inside the junction box as follows:

Black - Line
White - Neutral
Green - Ground

Cap any unused leads to prevent shorting. This fixture auto adjusts for voltages between 120VAC-277VAC.

4. Re-connect the male and female electrical connectors.
5. Attach the front cover to the backplate with the (4) screws previously removed.

Caution: Do not remove rubber seal for junction box installations.

SENSOR SETTINGS

■ Detection area

Detection area can be reduced by selecting the combination on the DIP switches to fit precisely for each specific application.

Note: Detection pattern increases in size as % increases.

■ Hold-time

Hold time means the time period to keep the lamp on 100%, after all motion has ceased (detection area vacated).

■ Daylight sensor

- I - Disable: The lamp always works, even during daylight.
- II - (50 Lux): The lamp works only in twilight and darkness.
- III - (10 Lux): The lamp works only in twilight and darkness.
- IV - (2 - Lux): The lamp works only in darkness.

■ Stand-by period (tri-level control)

This is the time period you would like to keep at the low light output level before it is completely switched off in the long absence of motion.

Note: "0s" means on/off control; "+ ∞" means bi-level control, fixture never switches off when daylight sensor is disabled.

■ Stand-by dimming level

This is the dimmed low light output level you would like to have after the hold-time in the absence of motion.

Default Settings (*)

	1	2	
I	●	●	100%
II	●	○	75%
III	○	●	50%
IV	○	○	10%

- I - 100%*
- II - 75%
- III - 50%
- IV - 10%

	1	2	3	
I	●	●	●	5s
II	●	○	○	30s
III	●	○	●	1min
IV	●	○	○	5min
V	○	●	●	10min
VI	○	●	○	20min
VII	○	○	○	30min

- I 5s
- II - 30s
- III - 1min
- IV - 5min*
- V - 10min
- VI - 20min
- VII - 30min

	1	2	
I	●	●	Disable
II	●	○	50Lux
III	○	●	10Lux
IV	○	○	2Lux

- I - Disable*
- II - 50Lux
- III - 10Lux
- IV - 2Lux

	1	2	3	
I	●	●	●	0s
II	●	○	○	10s
III	●	○	●	1min
IV	●	○	○	5min
V	○	●	●	10min
VI	○	●	○	30min
VII	○	○	●	1H
VIII	○	○	○	+∞

- I - 0s
- II - 10s
- III - 1min
- IV - 5min
- V - 10min
- VI - 30min
- VII - 1H
- VIII - +∞*

	1	2	
I	●	●	10%
II	●	○	20%
III	○	●	30%
IV	○	○	50%

- I - 10%
- II - 20%
- III - 30%
- IV - 50%*

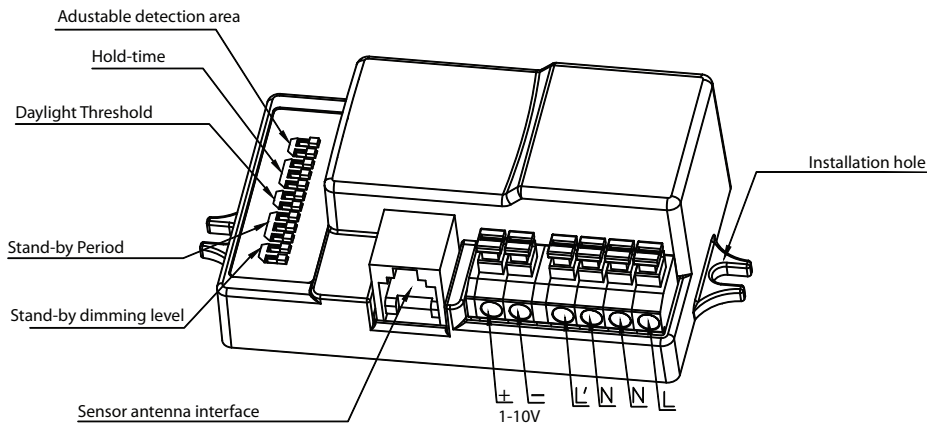

OPERATION

The SCS requires no special handling, power ON or power cycle requirements. We recommend routine inspections to visually verify the fixture is ON and emitting light. Refer to the troubleshooting guide for any unit not functioning correctly.

TROUBLESHOOTING

If the SCS does not turn ON:

1. Ensure that the sensor dip switches are fully engaged in the on or off position and all electrical connections are properly seated.
2. Check incoming voltage to the LED driver. Must be at least a minimum of 120VAC and not to exceed 277VAC.
3. If all LEDs on the engine are OFF, LED driver may be disconnected. Ensure driver(s) are secure. If secure, use voltmeter to check voltage is present at the output of the power supply. If low or no voltage, consult factory.
4. If some, but not all LEDs are working consult factory for additional technical support. Please have the catalog number and photos available when contacting technical support.